



WILSON
COLLEGE

A Place to Belong:

A Residence Hall Expansion Project at Wilson College

PROJECT AT A GLANCE

Beginning January 28, 2026, Wilson College launched construction on an exciting residence hall expansion project. This project represents a significant investment in the Chambersburg campus, driven by sustained enrollment growth and the College's commitment to providing a residential experience that supports student success, independence, and belonging.

The Residence Hall Expansion Project will:

- Add 21 new residential beds to campus
- Transform existing campus space into modern, apartment-style housing
- Support student recruitment, retention, and persistence
- Strengthen campus vitality while making efficient use of existing facilities

WHY WILSON COLLEGE IS UNDERTAKING THIS PROJECT

RESPONDING TO ENROLLMENT GROWTH AND HOUSING DEMAND

Over the past several years, Wilson has experienced sustained increases in enrollment, resulting in on-campus housing reaching full capacity. Living on campus remains one of the strongest predictors of student success, persistence, and engagement—particularly at an institution like Wilson. This expansion allows the College to meet current demand while planning responsibly for future growth. And, by reimagining existing spaces rather than constructing new facilities, this project reflects thoughtful stewardship of Wilson's resources.

SUPPORTING ACADEMIC, PERSONAL, AND RESIDENTIAL SUCCESS

Residence halls today are living-learning environments where students develop independence, form lasting relationships, and build essential life skills. Apartment-style housing plays an especially important role for students seeking greater autonomy while remaining fully engaged in campus life.

Apartment-style housing supports:

- Collaboration, communication, and shared responsibility
- Time management and personal accountability
- Balance between academic focus and personal well-being

All are core outcomes of a Wilson educational experience.

PROJECT DESCRIPTION

The Residence Hall Expansion transforms two areas of campus:

- The ground floor of Prentis Hall, and
- The space above the dining hall between McElwain and Davison Halls, known as The Platform

Through a partnership with a local architect and a regional construction firm, these areas are being reimagined into apartment-style residences and a small number of offices that support campus operations.

WHAT THE RENOVATION INCLUDES

Prentis Hall – Ground Floor

- Three 4-bedroom apartments (housing 12 students)
- One 3-bedroom ADA-accessible apartment (housing 4 students)
- One 1-bedroom apartment (housing 1 student)

The Platform (above the Dining Hall)

- Two 1-bedroom apartments for a graduate assistant and a teaching assistant
- One 2-bedroom apartment for a professional staff member
- Six offices supporting student and administrative needs

Total New Residential Capacity: 21 beds

PROPOSED RENOVATIONS THE PLATFORM

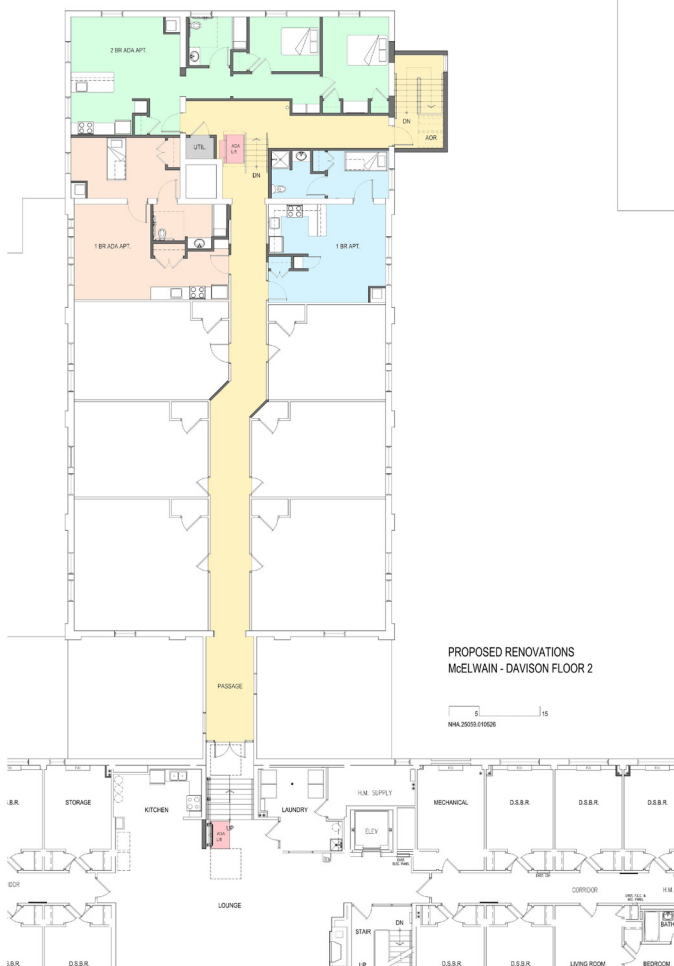

APARTMENT-STYLE LIVING: DESIGNED FOR TODAY'S STUDENTS

For alumnae and alumni, residence halls are often where lifelong friendships began—through late-night conversations, shared responsibilities, and moments of discovery.

This project builds on that legacy, ensuring that today's students experience the same sense of connection and belonging that has long defined Wilson College, just in a modern way that better suits their needs.

The new apartments provide amenities that support both academic focus and personal development, including:

- Private or semi-private bedrooms
- Shared living and kitchen spaces
- Greater autonomy within a supportive residential setting

This model is particularly attractive to upper-level students and those preparing for life beyond college, while still benefiting from the close-knit Wilson community.

PROPOSED RENOVATIONS LOWER LEVEL OF PRENTIS HALL



Proposed Lower Level of Prentis Hall
17 Beds in 4 - 4 Bed Suites + 1 - 1 Bed Suite

Scale: 0' 15'

NHA 25059.010526

AN INVITATION TO PARTNER

To fund these exciting developments, Wilson College has launched a fundraising campaign to support the \$4.0 million project goal. Naming opportunities are available at multiple levels, allowing donors to align their support with spaces that hold personal meaning while creating a lasting legacy on campus.

NAMING OPPORTUNITIES AND GIVING LEVELS

Prentis Hall – Ground Floor

- ▶ **The Prentis Floor** – \$750,000
- ▶ **Apartment A** – \$250,000
 - Bedrooms – \$50,000 each
- ▶ **Apartment B** – \$250,000
 - Bedrooms – \$50,000 each
- ▶ **Apartment C** – \$250,000
 - Bedrooms – \$50,000 each
- ▶ **Apartment D (ADA Accessible)** – \$250,000
 - Bedrooms – \$50,000 each
- ▶ **Apartment E (Resident Assistant)** – \$150,000
 - Bedroom – \$50,000
- ▶ **Laundry Room** – \$100,000

The Platform Apartments

- ▶ **Platform Apartments (overall naming)** – \$500,000
- ▶ **Apartment A (Graduate Assistant)** – \$150,000
 - Bedroom – \$50,000
- ▶ **Apartment B (Graduate Assistant)** – \$150,000
 - Bedroom – \$50,000
- ▶ **Apartment C (Professional Staff)** – \$200,000
 - Bedrooms – \$50,000 each

All naming opportunities are subject to final approval and availability and will be awarded on a first-commitment basis.



LOOKING AHEAD

Wilson College's ability to grow, adapt, and serve students has always been made possible by the belief and generosity of its community. By supporting the Residence Hall Expansion Project, you help ensure that Wilson remains a place where students feel at home—today and for generations to come.

For more information or to explore naming opportunities, please contact the Office of Institutional Advancement at advancement@wilson.edu or 717-262-2020.